

BEST FENCE PRO V6

INSTRUCTION MANUAL



FOR ALL BEST FENCE PRO SYSTEMS

SOME FEATURES AND ACCESSORIES MAY NOT BE INCLUDED WITH YOUR SYSTEM. PLEASE VISIT WWW.FASTCAP.COM FOR MORE DETAILS.

FastCap, LLC

5016 Pacific Highway
Ferndale, WA 98248

Toll Free: 1-888-443-3748

Phone: 1-360-752-2138

Fax: 1-360-650-1075

Web: www.fastcap.com

Email: info@fastcap.com

APRIL 2021

BEST FENCE PRO STAND SETUP

STEP 1

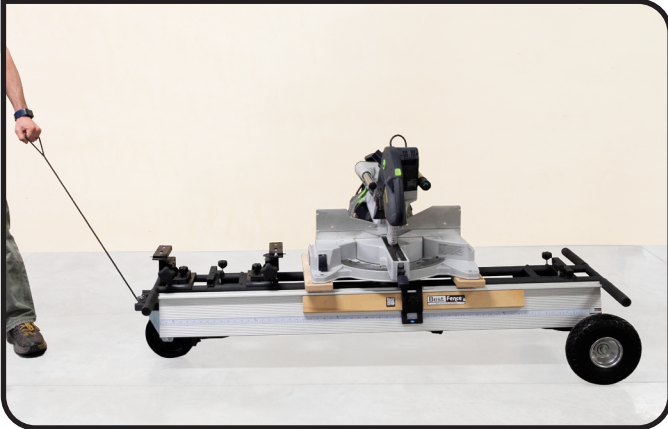

WHEEL STAND TO DESIRED LOCATION USING HANDLE

STEP 2



RELEASE LEGS BY PULLING HANDLES ON BOTH SIDES

STEP 3



LIFT SINGLE WHEEL SIDE FIRST AND PULL LEGS OUT. THE HIGHER YOU LIFT THE EASIER.

STEP 4



MAKE SURE BALL DETENT IS LOCKED IN STANDING POSITION

STEP 5



REPEAT ON OTHER SIDE TO FINISH STAND SETUP

STEP 6



WHEN FOLDING BACK UP, LIFT & FOLD THE 2-WHEEL SIDE FIRST

BEST FENCE PRO SAW SETUP

STEP 1



POSITION SAW MOUNT ON RAILS WITH PLASTIC BRACKET PARALLEL

STEP 2



ROTATE BRACKET 90° AND TIGHTEN KNOB TO LOCK IN PLACE

STEP 3



ALLOW ENOUGH SPACING FOR RACK WHEN APPLICABLE. USE PROPELLER NUTS TO PUT SAW IN BEST POSITION

STEP 4

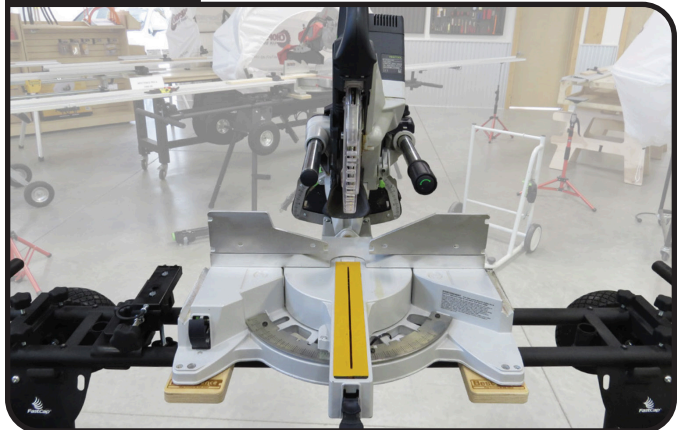

PLACE SAW ON RAILS, WAIT TO SCREW DOWN UNTIL FENCES ARE ALIGNED (PG. 3 & 4)

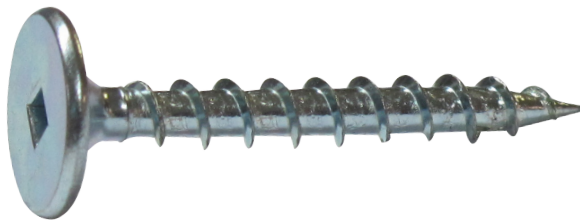

MOUNT SAW WITH PROVIDED POWERHEAD SCREWS (FOUND IN HARDWARE KIT)

BEST FENCE PRO FENCE SETUP

STEP 1



LOOSEN KNOBS AND PULL OUT ARMS FROM STAND. TIGHTEN KNOBS.

STEP 2



PLACE FENCE ON PRECISION ADJUSTMENT BLOCKS BY HOOKING THE BACKSIDE FIRST

STEP 3



ALIGN HOLE ON FENCE WITH LINE ON PRECISION ADJUSTMENT BLOCK AND INSERT PIN TO LOCK IN PLACE

STEP 4



USE LEVEL TO ALIGN FENCE WITH SAW. ONCE ALIGNED, SCREW DOWN SAW.

STEP 5

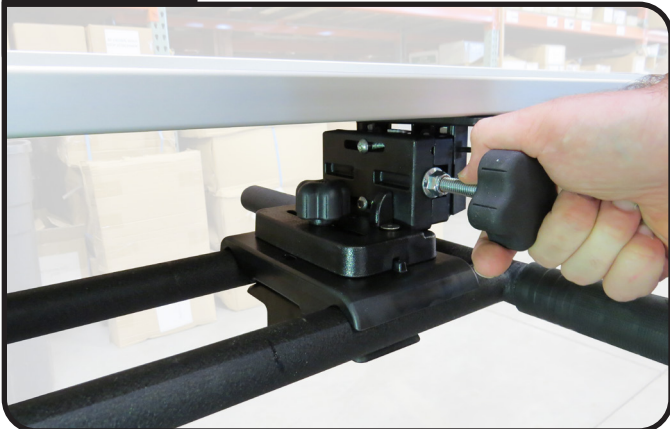

SIDE KNOB FOR HORIZONTAL ADJUSTMENTS

STEP 6



BOTTOM KNOB FOR HEIGHT ADJUSTMENT

BEST FENCE PRO BLOCK ALIGNMENT

STEP 1



**POSITION BLOCK ON RAILS WITH
BOTTOM BRACKET PARALLEL**

STEP 2



**LOOSEN AND HOLD ASSEMBLY WHILE
ROTATING BOTTOM BRACKET 90°**

STEP 3



**TIGHTEN ADJUSTMENT KNOB TO LOCK
BLOCK IN PLACE**

STEP 4



**FOR VIDEO INSTRUCTIONS ON
CONVERTING PABS TO A BEST
FENCE PRO SYSTEM**

TROUBLESHOOTING



**IF THERE IS EXCESS MOVEMENT IN THE PRECISION ADJUSTMENT BLOCK
TIGHTEN THE ALLEN SCREWS**

BEST FENCE MALE-MALE SETUP

STEP 1

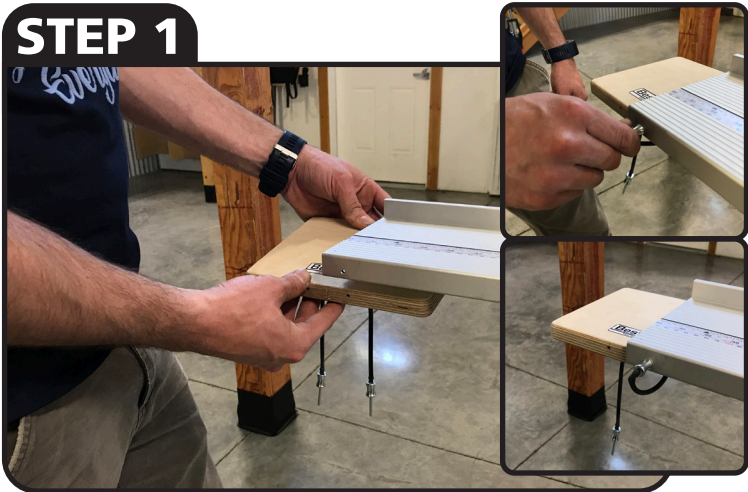

POSITION MALE-MALE CONNECTOR SO THAT FENCE END IS ON MIDDLE LINE. USE ATTACHED PIN TO SECURE IN PLACE.

STEP 2

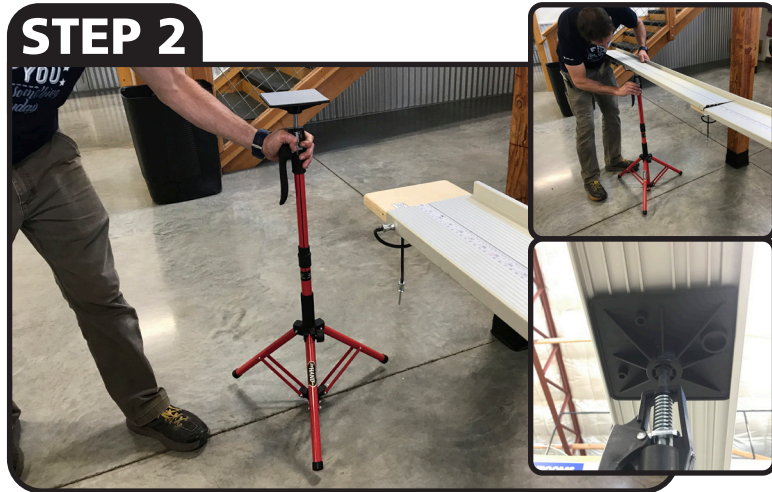

POSITION UPPER HAND AND ATTACHED SECOND FENCE

STEP 3

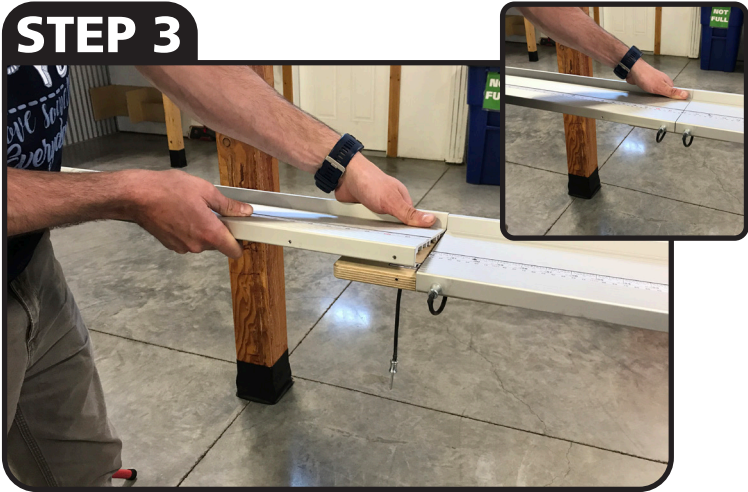

POSITION FENCE ONTO MALE-MALE CONNECTOR AND USE ATTACHED PIN TO SECURE IN PLACE

STEP 4



USE THE PRECISION PUMP JACK TO LEVEL FENCES

STEP 5

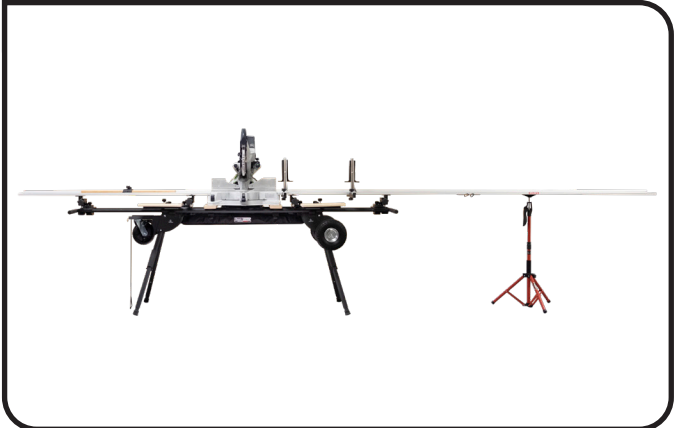

REPEAT STEP 1 - 4 ON SECOND FENCE

STEP 6



FOR VIDEO INSTRUCTIONS ON THE FENCE CONNECTOR SET UP

BEST FENCE PRO ACCESSORIES

STEP 1



ATTACH BAG RACK BY SLIDING POST INTO HOLE

ONLY AVAILABLE FOR BEST FENCE 3 OR 4, BEST FENCE PRO 3 OR 4

STEP 2

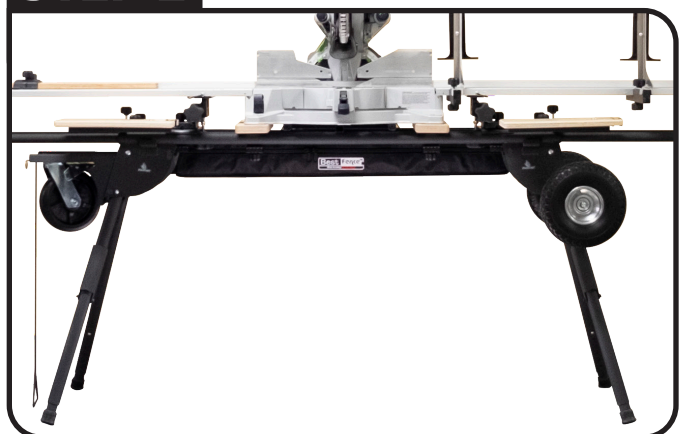

SLIDE BAG ONTO BAG RACK

ONLY AVAILABLE FOR BEST FENCE 3 OR 4, BEST FENCE PRO 3 OR 4

OPTION 1



INSERT WORK TABLE INTO ACCESSORY HOLE WHERE DESIRED & TIGHTEN KNOB TO SECURE

ONLY AVAILABLE FOR BEST FENCE 3 OR 4, BEST FENCE PRO 3 OR 4

OPTION 2

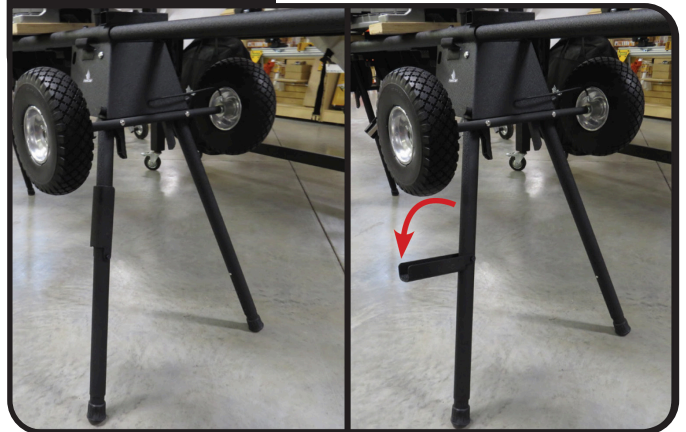

LUMBER RACKS CAN BE FOLDED OPEN TO SUPPORT EXTRA LUMBER

STEP 1



STEP 2



STEP 3

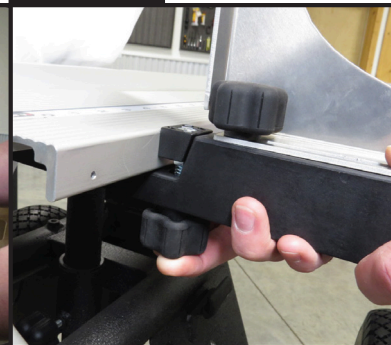

SCAN FOR VIDEO INST.



STEP 1: ATTACH ARM BY HOOKING REAR FIRST THEN TIGHTENING WEDGE KNOB

STEP 2: ADJUST L-BRACKET AND PLASTIC SLIDE TO FIT SIZE OF YOUR CROWN MOLDING

STEP 3: TO REMOVE ARM, SLIDE ALL PIECES OFF THE BEST FENCE. UNSCREW BOTTOM KNOB AND PUSH UP TO RELEASE WEDGE FROM BEST FENCE.

BEST FENCE PRO BLOCK SPACER

STEP 1

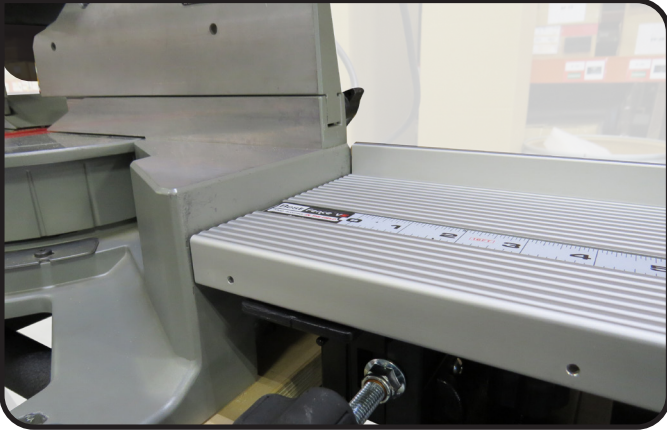

**SOME SAWS HAVE HIGHER DECKS
REQUIRING SPACERS FOR PRECISION
ADJUSTMENT BLOCKS**

STEP 2

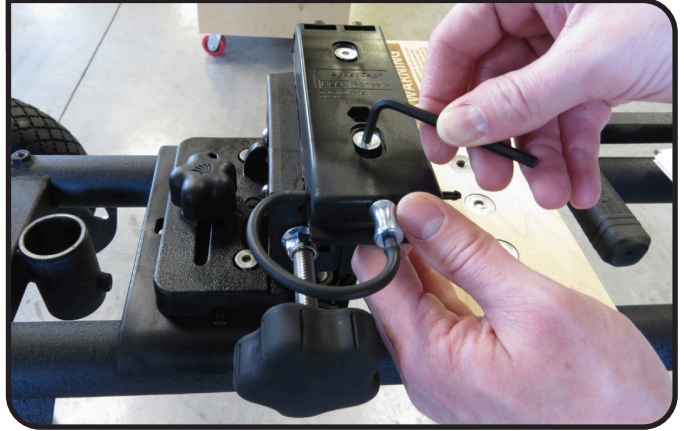

**REMOVE FENCE AND UNSCREW TOP
PLATE FROM BLOCK WITH INCLUDED
WRENCH**

STEP 3



**INSTALL INCLUDED SPACERS
TO TOP PLATE**

STEP 4



**INSTALL TOP PLATE INTO PRECISION
ADJUSTMENT BLOCKS**

TROUBLESHOOTING

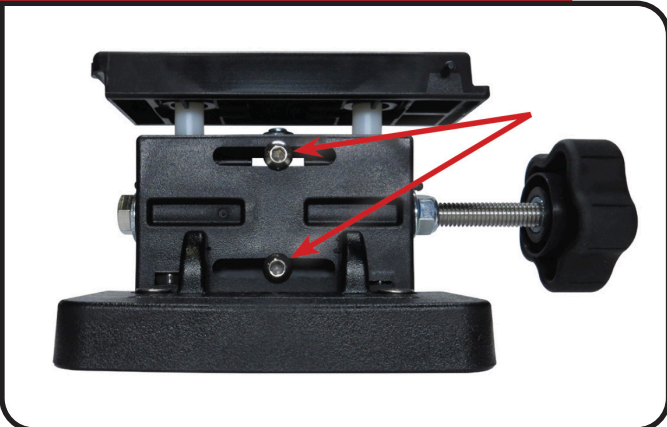

**IF THERE IS EXCESS MOVEMENT IN
THE PRECISION ADJUSTMENT BLOCK
TIGHTEN THE ALLEN SCREWS.**

SEE PAGE 4 FOR MORE DETAIL

PAB ADJUSTMENTS



**ADJUST SET SCREWS TO CHANGE
FORWARD/BACKWARD PITCH OF
PAB IF NECESSARY**